

SANTEC

FLUID IMAGINATION



DESIGNER SERIES

Installation Instructions

Ceiling rain head arm and flange

KEEP THIS INSTRUCTION BOOKLET FOR FUTURE REFERENCE

Important: Santec reserves the right to request additional documents before servicing warranty requests.

SANTEC has the right to make necessary design changes where applicable

*Illustration may not depict actual products

Ceiling Arm Installation

Note: Hole size for the ceiling arm is a minimum of 1-1/4 and maximum of 1-1/2. The pipe should be roughed in flush with the wall or deeper.

1

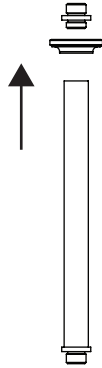

Step 1:
Remove the nut from the top of the ceiling arm and slide the flange onto arm. Wrap Teflon tape around the threads and thread the nut back onto the arm.

2

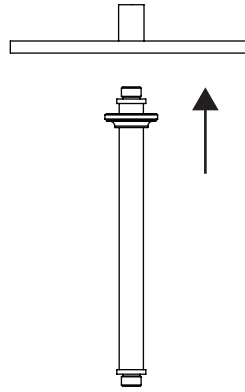

Step 2:
Wrap the other end of the threads with Teflon tape and thread onto the pipe in the wall.

3

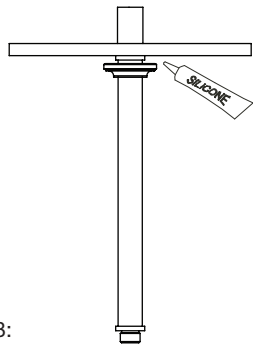

Step 3:
Apply silicone around the hole and press the flange to secure its position.

4

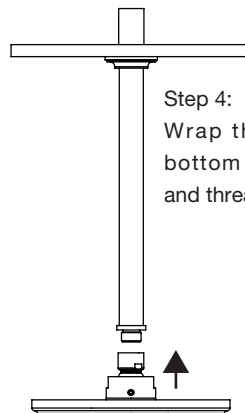

Step 4:
Wrap the threads at the bottom of the ceiling arm and thread on the rain head.

*Illustration may not depict actual products