

SANTEC

FLUID IMAGINATION

DESIGNER SERIES

TOWEL BAR

HAND TOWEL BAR

TOILET PAPER HOLDER



PARTS BREAKDOWN

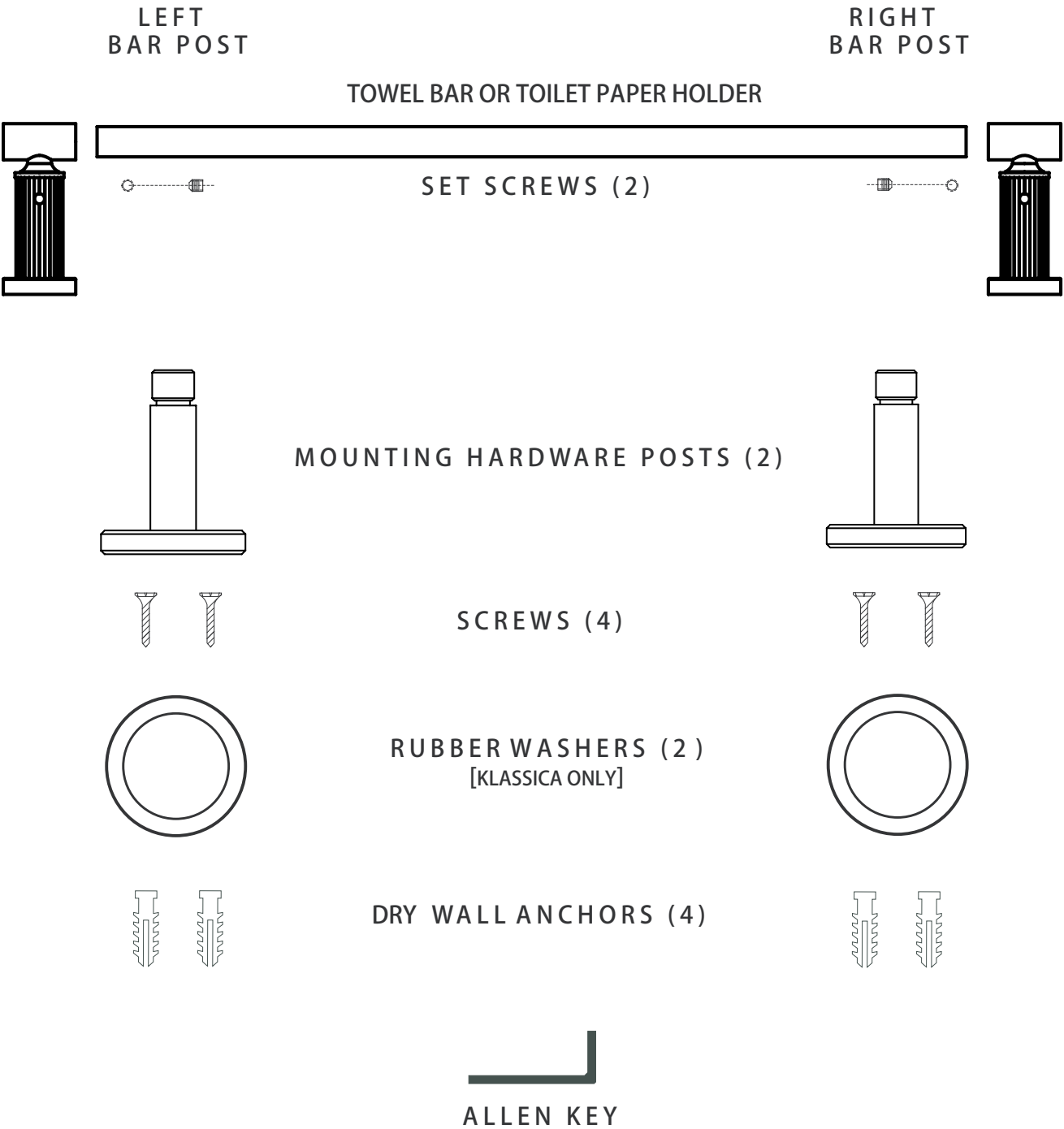

TOWEL BAR, HAND TOWEL BAR & TOILET PAPER HOLDER

Remove the mounting hardware posts from the bar posts and use them as references for positioning. Make sure that the bar/toilet paper holder spindle position is correct and leveled.

Measuring the Mounting Hardware Posts

Mark the first mounting hardware post at the desired height, use the mounting hardware post to mark the four screw hole positions. Slip the towel bar/toilet paper holder spindle into the two bar posts. Place assembly on the wall, one post should overlap the marked screw hole positions. Mark above, below, right, and left of the post with a pencil and remove the assembly. Connect the two lines to find the center.

Place the other mounting hardware post over the mark, opposite from the first mounting hardware post, and check with a level to make sure the height of both is the same. When level and centered, mark the second post's screw hole positions.

Installing On Wooden Surface

For wooden surface, the mounting hardware posts can be secured by threading the screws directly into the wall.

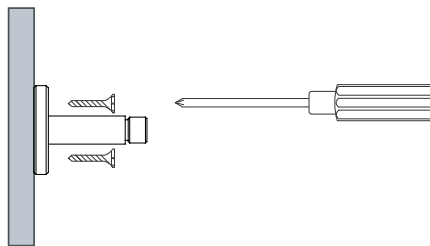

TOWEL BAR, HAND TOWEL BAR & TOILET PAPER HOLDER

Installing On Solid/Hard Surface and Drywall

Measure the dimensions carefully, mark the four screw hole positions by using the mounting hardware post. Using a drill, pre-drill the holes. Insert anchors into the wall. Secure the mounting hardware posts by tightening the screws into the anchors.

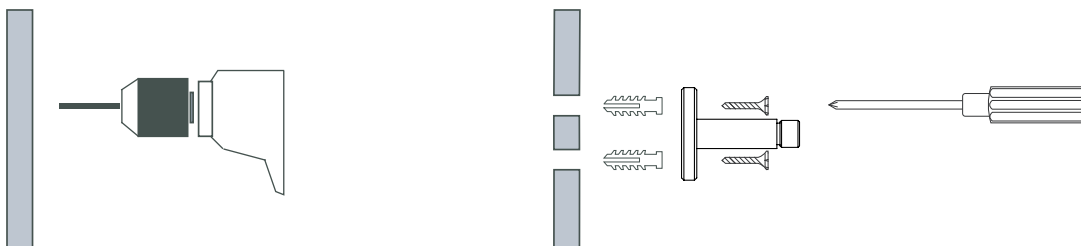

Securing in Position

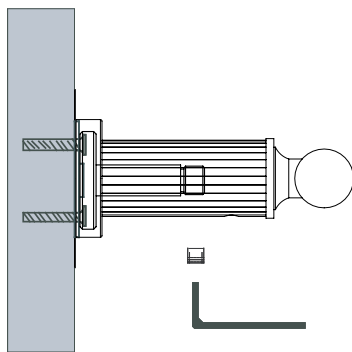

Using the allen key provided, loosen the set screws from the bar posts.

Insert the towel bar/toilet paper holder spindle into both left and right bar posts.

***For Klassica models, make sure there is a rubber washer underneath each bar post flange.**

Make sure the assembly is fitted together securely.

Lift the assembly to the wall and align with the mounting posts.

Slip the assembly over the left and right mounting hardware posts.

Adjust the bar posts if necessary and secure by firmly tightening the set screws with the provided allen key.