

# Installation Instructions

1. Place the robe hook against the assigned wall location. Make sure that the robe hook is leveled. Mark the robe hook position.

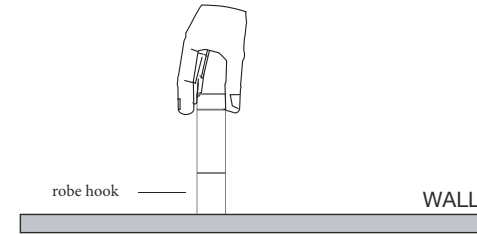

2. Using the Allen key provided, remove the robe hook from the mounting post. Press the mounting post against marked robe hook position on the wall and mark the screw hole positions.

NOTE: MAKE SURE THE ALLEN SCREW HOLE ON THE ROBE HOOK IS FACING DOWN WHEN SECURING TO WALL.

## INSTALLING ON WOODEN SURFACE

For wooden surface, the mounting post can be secured by screwing the screws directly into the wall.

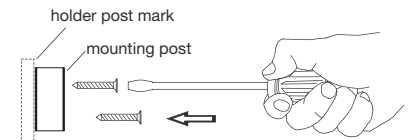

## INSTALLING ONTO DRYWALL SURFACE

Using a drill, pre-drill holes for the anchors. Insert the anchors into the wall. The mounting post can be secured by screwing the screws into the anchors.

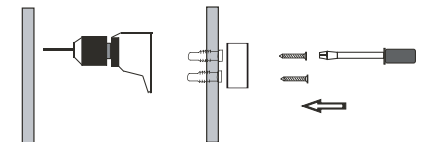

## INSTALLING ONTO A SOLID SURFACE

Measure the dimensions carefully. Using a drill, pre-drill the holes. Secure the mounting post by screwing the screws into the wall.

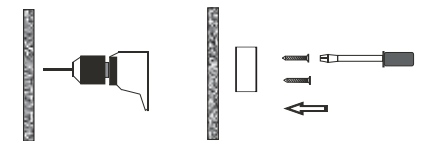

# Installation Instructions

---

3. Press the robe hook over the mounting post. Align the robe hook and secure it by tightening the set screw.
4. Check the robe hook to make sure it is firmly secured. If not, tighten the set screw with the Allen key.

