

*Illustration may not depict actual products

Spout

Spout Installation

NOTE: The length of threaded pipe coming out from the finish wall should be no longer than 1/2".

Wrap the pipe threading for the spout with Teflon tape. Then thread the spout onto the pipe until it is secured with the spout facing downward.

WARNING: Do not use excessive force when threading the spout.

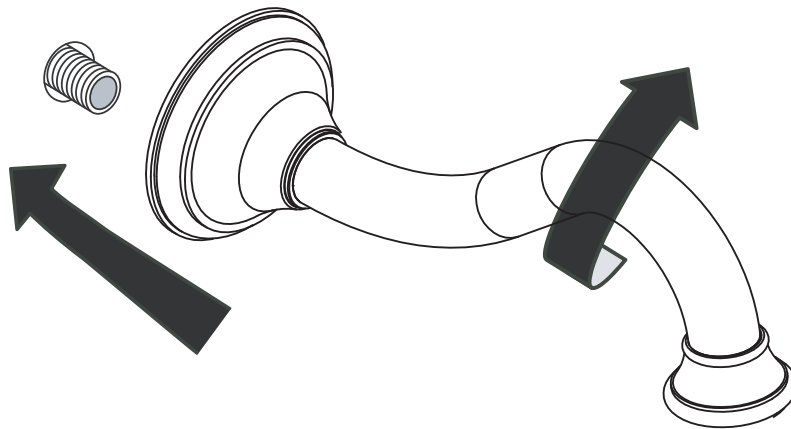

Quick Connect Spout

Spout Installation

If spout comes with a quick connect, follow the below instructions.

NOTE: The length of threaded pipe coming out from the finish wall should be no longer than 1/2".

Wrap the pipe threading for the spout with teflon tape. Then, thread the spout quick connect onto the pipe until it is secured.

WARNING: Do not use excessive force when threading the spout.

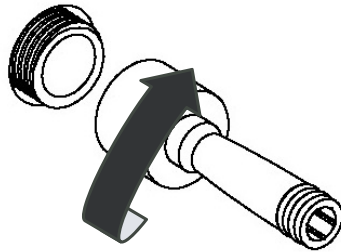

Insert the spout, with its flange attached and spout facing downward, into the quick connect. Lock the spout with two set screws located at the bottom spout near the flange.

